

DRAWING NO. XRL-G03

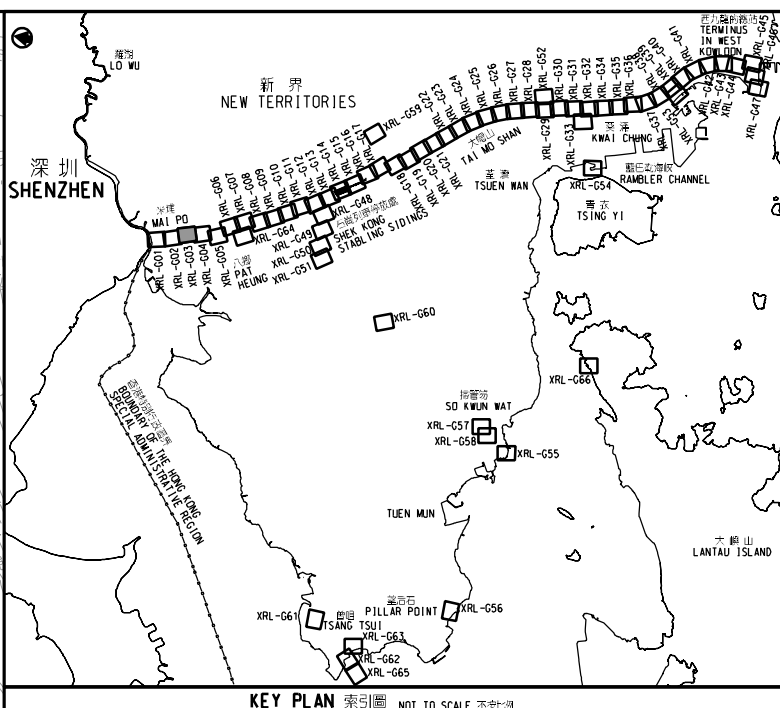

- 圖例 LEGEND**
- 方案界線 BOUNDARY OF THE SCHEME
 - 擬建的車站及其他鐵路設施 PROPOSED STATION AND OTHER RAILWAY FACILITIES
 - 擬建的車站及其他鐵路設施(地下) PROPOSED STATION AND OTHER RAILWAY FACILITIES (UNDERGROUND)
 - 擬建的鑽挖或掘或鑽爆隧道 PROPOSED BORED / MINED / DRILL AND BLAST TUNNEL
 - 擬採用明挖回填法興建的鐵路設施或隧道 PROPOSED RAILWAY FACILITIES/TUNNEL BY CUT-AND-COVER METHOD
 - 擬建的地下臨時建築通道 PROPOSED TEMPORARY UNDERGROUND CONSTRUCTION ACCESS
 - 可能永久封閉的道路(包括行車道和行人徑) WHICH MAY BE CLOSED PERMANENTLY
 - 擬建的緊急車輛通道及行車道 PROPOSED EMERGENCY VEHICULAR ACCESS AND CARRIAGEWAY
 - 擬建的行人徑 PROPOSED FOOTPATH
 - 現有的行人天橋將受影響 EXISTING FOOTBRIDGE TO BE AFFECTED
 - 擬建的臨時行人天橋/地面行人過路處 PROPOSED TEMPORARY FOOTBRIDGE / AT-GRADE PEDESTRIAN CROSSING
 - 擬建的行人天橋 PROPOSED FOOTBRIDGE
 - 可能在其上進行填海工程或其他工程的政府前濱或海床 OVER OR UPON WHICH RECLAMATION OR OTHER WORKS MAY BE CARRIED OUT
 - 圖則修改 DRAWING REVISION
 - 修訂參考編號(參考憲報公告) AMENDMENT REFERENCE NUMBER (SEE GAZETTE NOTICE)
 - 修訂範圍 AMENDMENT AREA

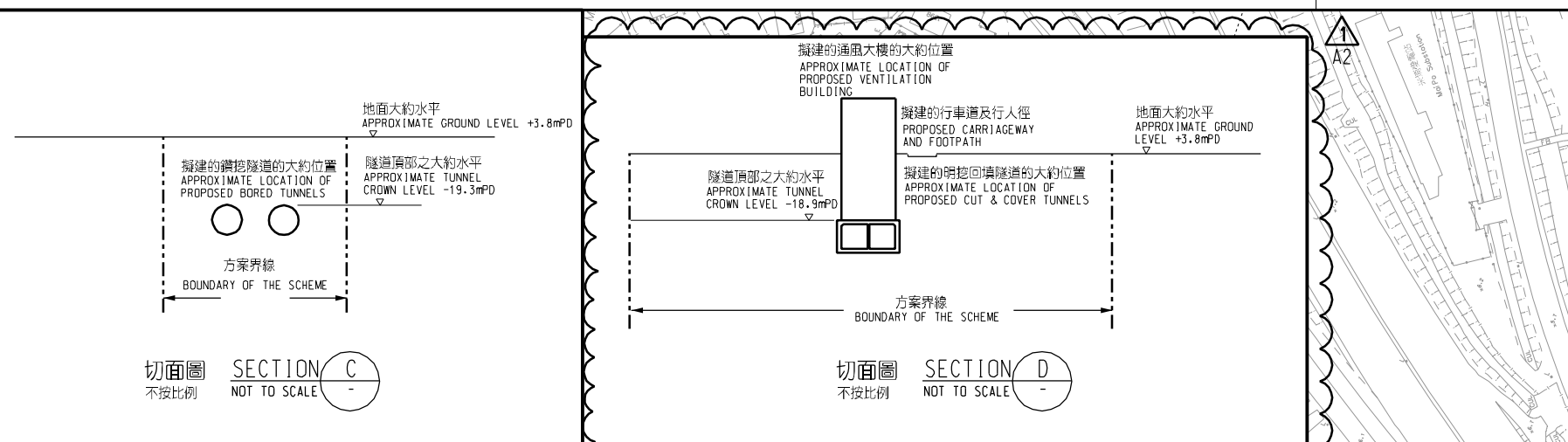
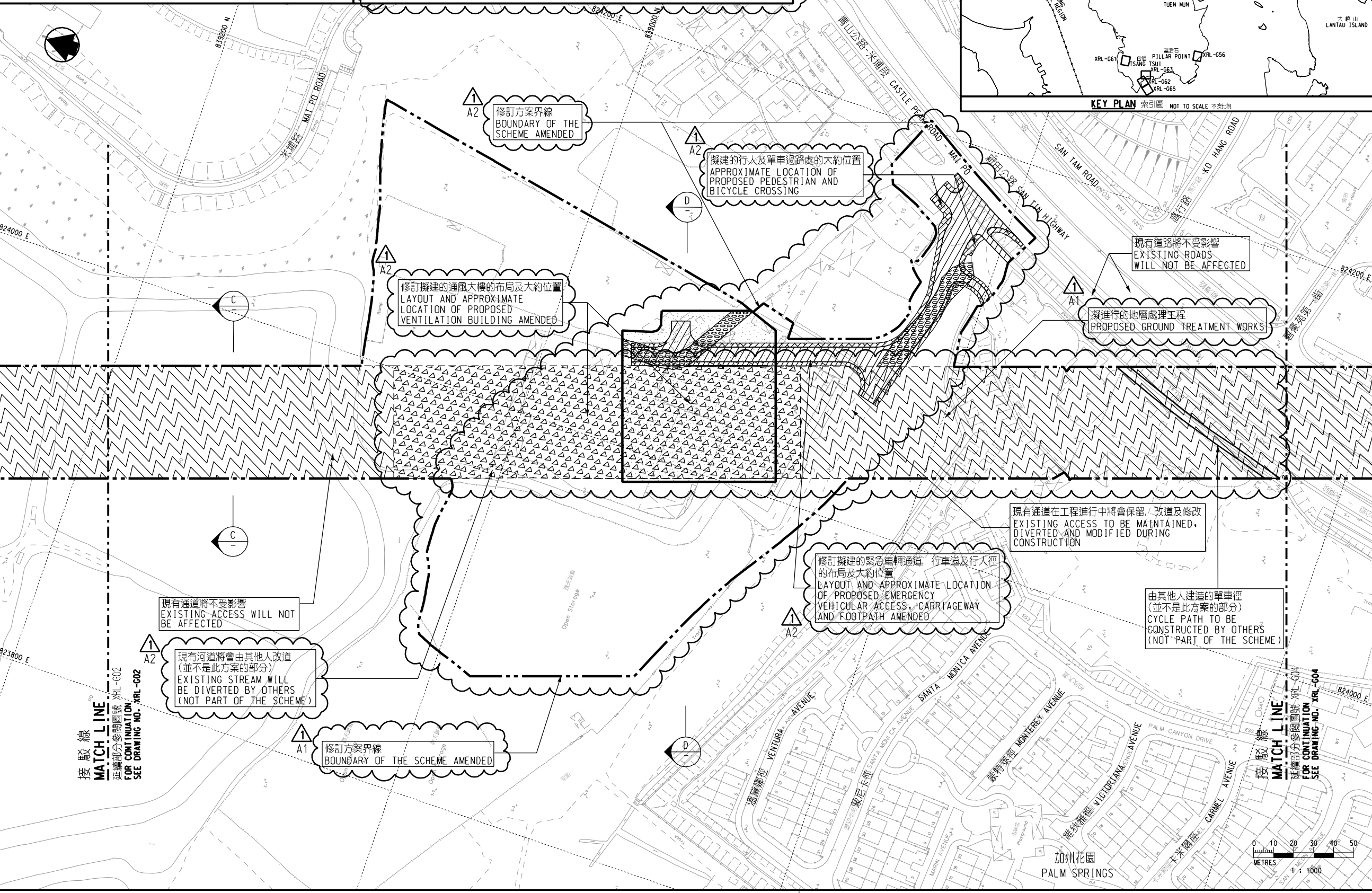

一般說明 GENERAL NOTES

1. 有關一般說明參閱圖號 XRL-G01.
FOR GENERAL NOTES, REFER TO DRAWING NO. XRL-G01.

修訂表 TABLE OF AMENDMENTS				
修訂日期 REV	修訂日期 DATE	修訂人 BY	修訂內容 SUB	說明 DESCRIPTION
17 APR 2005	CADD	DD	PP	修訂項目 A1 及 A2 AMENDMENT ITEMS A1 AND A2 修訂圖則方格內內容及索引圖 TITLE BOX AND KEY PLAN AMENDED

獲准發出 APPROVED FOR ISSUE

路政署
鐵路發展處處長(2)
GOVERNMENT ENGINEER/
RAILWAY DEVELOPMENT (2)
HIGHWAYS DEPARTMENT

發出日期 DATE OF ISSUE

圖則名稱 DRAWING TITLE
廣深港高速鐵路香港段
鐵路條例(第519章)
總體規劃圖則 66頁的第3頁
HONG KONG SECTION OF
GUANGZHOU - SHENZHEN - HONG KONG
EXPRESS RAIL LINK
RAILWAYS ORDINANCE (CHAPTER 519)
GENERAL LAYOUT PLAN SHEET 3 OF 66

圖號 DRAWING NO. XRL - G03

比例 SCALE 1:1000 (A1)
或如顯示
AS SHOWN

香港特別行政區政府
THE GOVERNMENT OF THE HONG KONG
SPECIAL ADMINISTRATIVE REGION

路政署
HIGHWAYS DEPARTMENT

鐵路拓展處
RAILWAY DEVELOPMENT OFFICE

